

Another **Prospector**
staking new ground



Durable

Powerful

Dependable

PROSPECTOR II

PROSPECTOR II

The Prospector II is a compact highly maneuverable rig that can climb steep grades and sets up quickly and easily once on site. The hydraulic tilt deck insures safe and secure drilling on side hills. The 4-way dozer blade is ideal for light site preparation and doubles as the front stabilizer. Powered by industry accepted Cummins 177 HP diesel the **Prospector II** gets the job done.



The Prospector II is truly a job-ready reverse circulation drill rig. With its on-board compressor, cyclone, combination swivel, B.O.P, on-deck tooling rack, DTH oiler and DTH water injection, seldom is a support vehicle required.

With the turn of the key this competitively priced rig is ready to deliver samples.

Engineered by **Multi-Power Products Ltd.**, a name you can trust.

Prospector II Specifications

STANDARD FEATURES

- Full RC drilling package
- Racor fuel filter
- Casing seal (B.O.P.)
- Sampling cyclone
- Redco XL slider on top drive
- Fully instrumented driller control panel
- Heavy duty battery
- Halogen driving lights
- Hydraulic tilt deck
- On board rod rack
- Will ship in standard sea container

ENGINE

Cummins Diesel 6BTA5.9, 177 HP @ 2,500 rpm

FEED

- Head travel standard stroke = 144 in (3,657 mm)
- Pull Up = 12,400 lbs (5,624 Kg)
- Pull Down = 8,200 lbs (3,719 Kg)

ROTARY

- 2,500 ft. lb. standard torque
- Optional torque ranges available
- 0-110 Standard Speed range

HYDRAULICS

- Sundstrand 45 series open loop
- Utility pump

OIL INJECTION

- Air operated injection pump
- Variable output
- Oil heated

WATER INJECTION

- FMC Bean injection pump
- 8 GPM standard
- Optional sizes available

COOLING

- Engine, compressor and hydraulic coolers designed for ease of cleaning

CAB

- Ergonomic seat
- Joy stick for travel
- Joy stick for blade

CARRIER

- American Undercarriage
- B1L Series
- 10,000 lb (4,535 Kg) draw bar pull



The Prospector II working in Slovakia

Prospector II Specifications

DOZER BLADE

- 89 in (2,260 mm) wide
- Hydraulic raise and lower
- Hydraulic tilt
- Light dozing and pad preparation
- Stabilizer

MAST

- 38 in (965 mm) axial slide (dump)
- 45° + angle hole capability

CLUTCH

- Direct drive through flexible element
- Dog style
- Shiftable with engine stopped

COMPRESSOR

- GHH 90 Series
- 300 CFM @ 220 psi

SWIVEL

- Combination design
- Air inlet and discharge positioned above top drive rotary
- Easy service features

DIMENSIONS

- Weight with fluids but with no rods is approximately 14,000 lbs (6,360 Kg)
- Dozer blade is 89 in (2,260 mm) wide
- Track width is 84 in (2,133 mm)
- Track length is 99 in (2,514 mm)
- Mast down transport height is 92 in (2,336 mm)

OPTIONAL

- Coring package
- Hydraulic breakout wrench

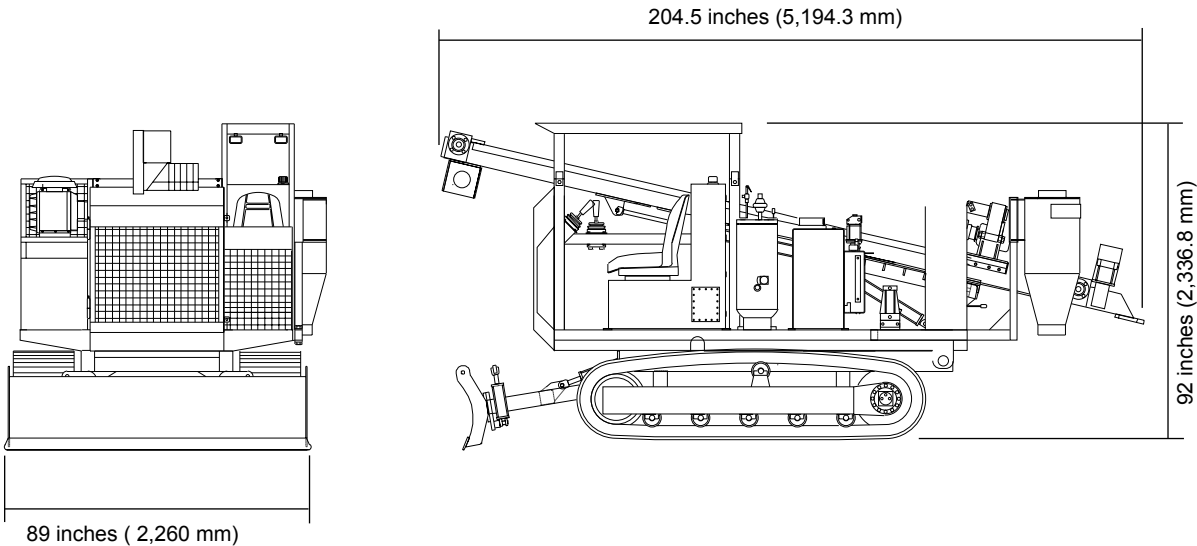

Performance ratings are based on engineering specifications, calculations and accepted industry standards. Capacities may vary according to drilling conditions. The drawing and photographs are for illustrative purposes only. Multi-Power Products Ltd. reserves the right to amend these specifications at any time, without notice.



www.multipowerproducts.com

Email: sales@multipowerproducts.com

Tel: 1 (250) 860 - 6969 Fax: 1 (250) 860 - 3340
975 Crowley Avenue, Kelowna, BC CANADA V1Y 9R6

Printed in Canada
PROI10304